

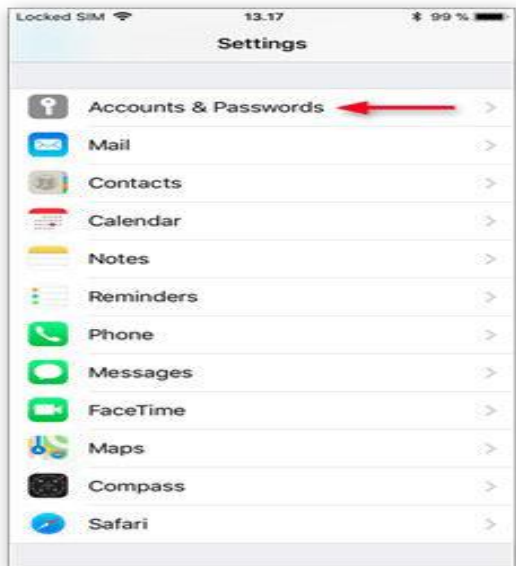

## Manual for setting account in IOS Step 1 - Go to Settings > Accounts & Passwords

Open **Settings** on your iPhone and tap **Accounts & Passwords**.



## Step 2 - Tap Add account

Tap **Add account**.

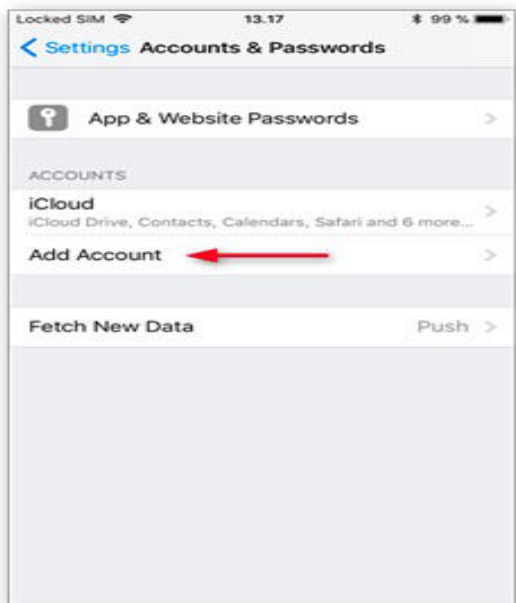

## Step 3 - Tap Other

Select **Other** as account type.

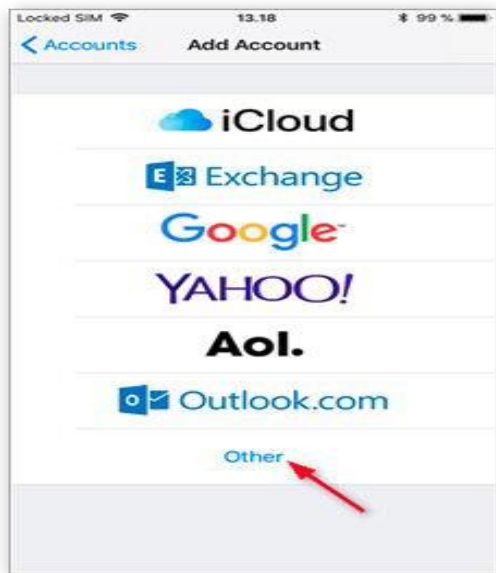

## Step 4 - Tap Add Mail Account

Tap Add Mail Account.

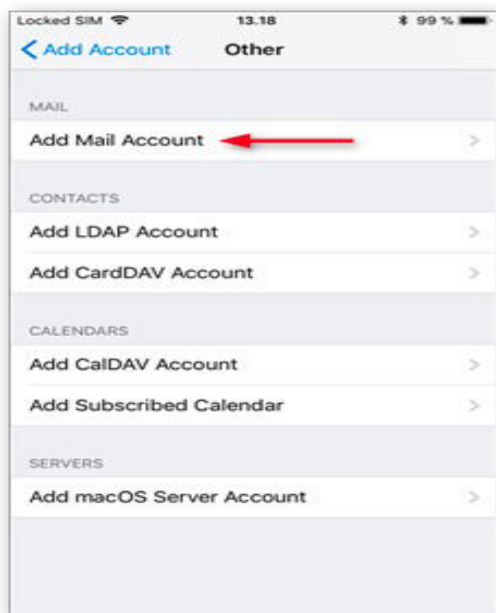

## Step 5 - Enter your account details

Enter the account details for the email you want to add:

- **Name:** this will be visible as the sender.
- **Email:** the address you want to add.
- **Password:** you use it to log in to Webmail.
- **Description:** a name for the account on your device.

Tap **Next** to continue.

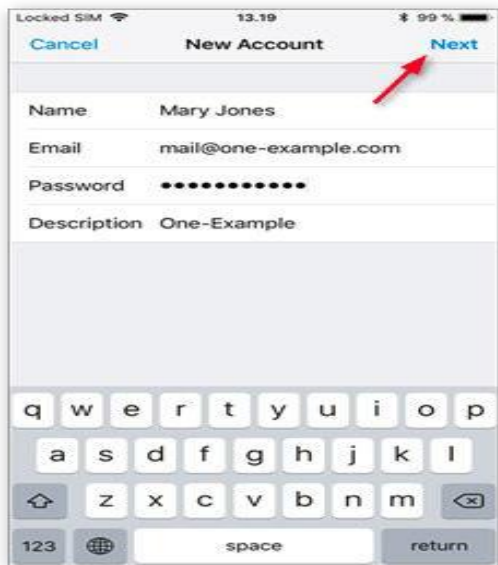

IMAP protocol:

(Note: These settings are useful when mails are being accessed from multiple devices.)

POP3 protocol:

(Note: Mails configured as POP3 will be downloaded to the device and should not be used while accessing mails through multiple devices.)

## Step 6 - Select IMAP

Tap **IMAP** as the account type.

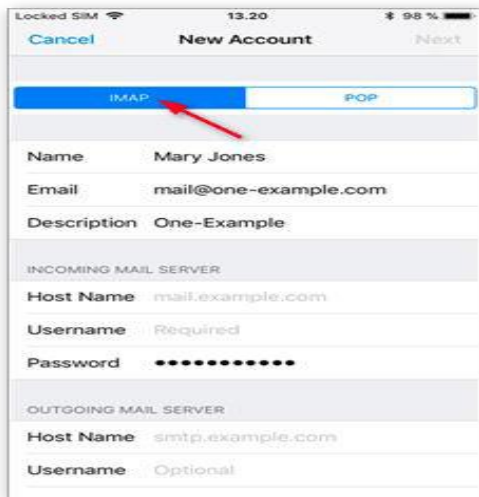

## Step 7 - Enter your server settings

Enter the following settings:

### Incoming server:

- Host name: **i.mail25.info**
  - User name: your email account
  - Password: the one you use for Webmail

### Outgoing server:

- Host name: **s.mail25.info**
  - User name: your email account
  - Password: the one you use for Webmail

Tap **Next** to continue.



## Step 8 - Save the account

Disable syncing of Notes, if this is enabled. Tap **Save**.

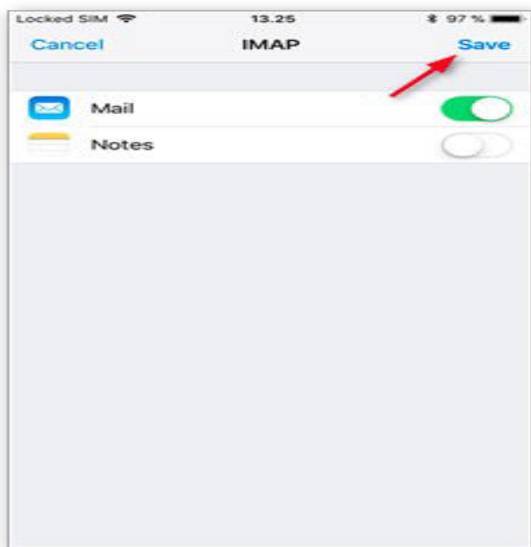

## Step 9 - Tap the account you added

Tap the account you just added. You can recognize it by the description.

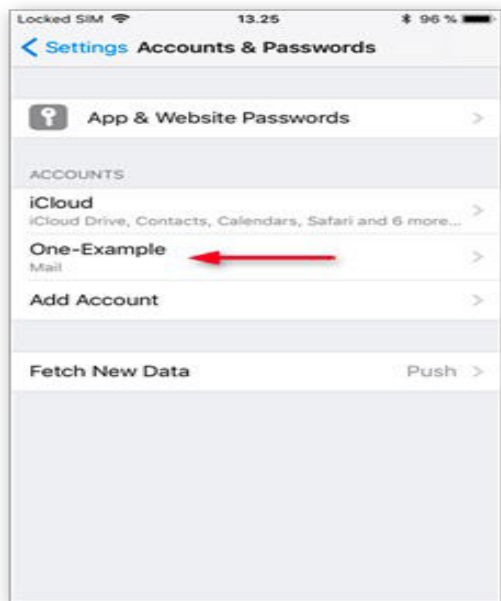

## Step 10 - Tap your account again

Tap your account again to open settings.

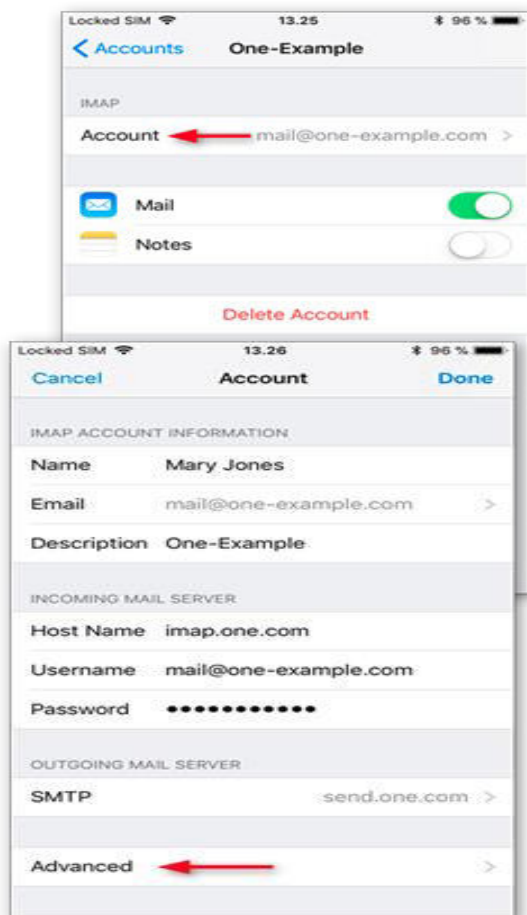

## Step 11 - Tap Advanced

Tap **Advanced**, at the bottom of your screen.

## Step 12 - Check Mailbox behaviors

Check if the **Mailbox behaviors** are set correctly. These settings determine where your emails are saved.

You need to select the following folders **on the server**:

- Drafts mailbox: **Drafts**
- Sent mailbox: **Sent**
- Deleted mailbox: **Trash**
- Archive mailbox: **Archive**

If no folder, or a different one is selected, tap the mailbox and select the correct folder **on the server**. The name of the folder is in English.

**Note:** If the folder is not listed, log in to Webmail and place an email in the folder that is not available. Then try again.

## Step 13 - Enter IMAP Path Prefix

Scroll down to the bottom of the screen and enter **INBOX** as IMAP path prefix, all in capitals.

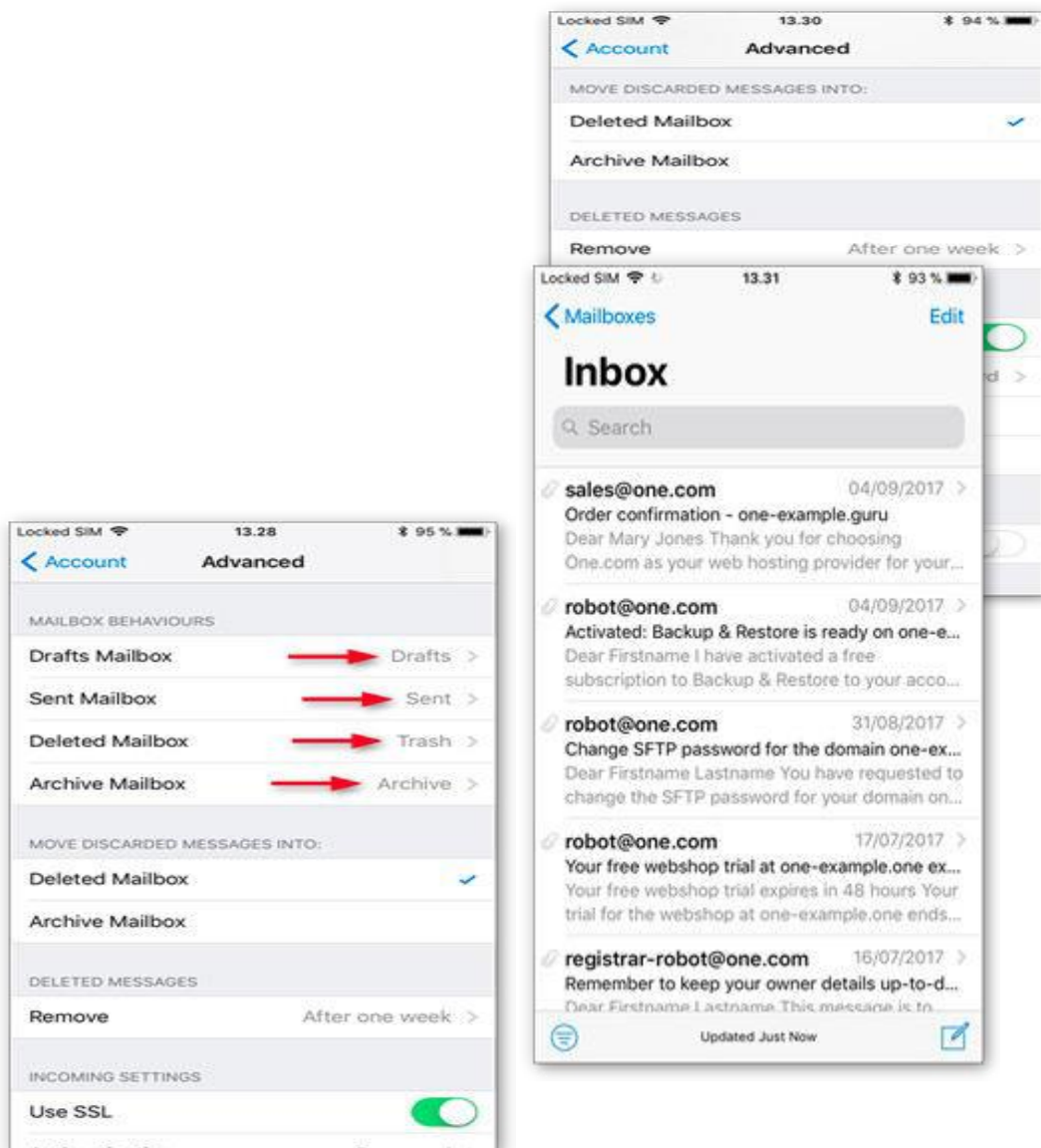

**Step  
14 -  
Done!**

## **Step 14 - Done!**

Your account is now set up correctly.